

DETAIL LEGEND

- 1 TYPE 'A' CONCRETE CURB
- 2 90" PARKING STALL
- 3 CONCRETE SIDEWALK, 5' WIDE UNLESS OTHERWISE NOTED
- 4 STANDARD DUTY ASPHALT
- 5 HANDICAP PAVEMENT MARKINGS
- 6 HANDICAPED PARKING SIGN
- 7 LIGHT POLE FOUNDATION
- 8 HANDICAP PAVEMENT RAMP
- 9 CROSSWALK STRIPING
- 10 INVERTED 'U' BICYCLE RACK

NOTE LEGEND

- 1 EDGE OF PAVEMENT
- 2 ROUNDT CURB IN 2' OR MATCH EXISTING CURB
- 3 INSTALL 'NO PARKING' SIGN, M.U.T.C.D. SIGN NO. R7-1C
- 4 LANDSCAPED AREA - SEE LANDSCAPE PLAN, IF NO PLANTINGS, INSTALL TOPSOIL & SEED
- 5 MATCH EX. PAVEMENT, SAWCUT AS REQ'D TO ACHIEVE SQUARE EDGE TO MATCH
- 6 ELECTRIC VEHICLE CHARGING STATION
- 7 INSTALL 'THREE LANE NO PARKING' SIGN

SITE NOTES:

- ALL RADII SHALL BE 3'-0" UNLESS OTHERWISE NOTED.
- ALL DISTURBED AREAS: SHALL HAVE 4" MIN. OF TOPSOIL AND SEED.
- ALL DIMENSIONS FROM PROPERTY LINES SHALL BE MEASURED PERPENDICULAR TO THE PROPERTY LINE.
- CENTER ENTRANCE SIDEWALKS ON DOOR OPENINGS.
- BUILDING DIMENSIONS ARE APPROXIMATE, REFER TO ARCHITECTURAL DRAWINGS FOR LAYOUT DIMENSIONS.

GENERAL NOTES:

- INSTALL ALL MATERIALS TO MANUFACTURER'S RECOMMENDATIONS AND BEST STANDARDS OF TRADE INVOLVED.
- SUBSTITUTIONS SHALL BE MADE ONLY WITH OWNER'S APPROVAL AND BE OF EQUIVALENT QUALITY TO WHAT IS SPECIFIED.
- WORK SHALL BE COMPLETED IN STRICT ACCORDANCE WITH ALL LOCAL CODES AND OSHA SAFETY RULES AND REGULATIONS.
- VERIFY ALL EXISTING CONDITIONS AND DIMENSIONS AT THE SITE. NOTIFY OWNER & ENGINEER OF DISCREPANCIES IN CONDITIONS SHOWN ON DRAWINGS PRIOR TO PROCEEDING WITH THE WORK.
- CONTRACTOR SHALL BE RESPONSIBLE FOR PROTECTION OF ANY EXISTING STRUCTURES TO REMAIN AND ANY FINISH MATERIAL INSTALLED WHILE WORKING ON OTHER COMPONENTS.
- CONTRACTOR SHALL KEEP JOB FREE OF DEBRIS AND MAKE FINAL CLEANUP TO SATISFACTION OF OWNER.
- CONTRACTOR SHALL ASCERTAIN THE LOCATION OF ALL UTILITIES PRIOR TO CONSTRUCTION SO THAT THIS WORK WILL NOT DISTURB EXISTING LINES AND/OR INSTALLATIONS. COORDINATE ALL WORK WITH THE APPLICABLE UTILITY COMPANIES.
- ALL OTHER PERMITS REQUIRED BY STATE OF NEW YORK, COUNTY OF ERIE, AND TOWN OF AMHERST ARE THE RESPONSIBILITY OF THE CONTRACTOR/DEVELOPER/OWNER.

SITE LEGEND

- PROPERTY LINE
- PROPOSED CURBING
- PROPOSED SIDEWALK / CONCRETE PAD
- NUMBER OF PARKING SPACES
- PROPOSED SIGN
- PROPOSED STANDARD DUTY ASPHALT PAVEMENT
- PROPOSED LIGHT POLE

Site Data

SITE AREA = 2.25 AC± (6.05 AC OVERALL)  
ZONED: CTR-5  
USE: PROPOSED 4-STORY MULTI-FAMILY BUILDING

SETBACKS - BUILDING	REQUIRED	PROVIDED
FRONT	0.0' MIN.	N/A
COMMON LOT LINE	0.0' MIN.	N/A
ALLEY	5.0' MIN.	N/A
SETBACKS - PARKING		
FRONT	20.0' MIN./25.0' MIN.	10.09' *
COMMON LOT LINE	0.0' MIN.	N/A
ALLEY	0.0' MIN.	N/A
TOTAL VEHICLE SPACES	81	100
BICYCLE	20	20
ELECTRIC VEHICLE STATION	1	12
GREENSPACE		
INTERIOR PARKING GREENSPACE:	5% (2,135 SF)	8.3% (3,560 SF)
OVERALL OPEN SPACE:	5% (0.12 AC)	29.8% (0.67 AC)
MAX. BUILDING HEIGHT	5-STORY / 75'	4-STORY / 50.25'

\* PRE-EXISTING CONDITION

PARKING CALCULATION (per Section 5A-9-1-A)

APARTMENTS:  
REQ'D: 1 space per 1/2 bdrm unit  
REQ'D = 1 x 81 units = 81 SPACES

BICYCLE CALCULATION (per Section 5A-9-1-A)

APARTMENTS:  
REQ'D: 0.5 space per unit (20 max.)  
REQ'D = 0.5 x 81 = 40 = 20 SPACES REQ'D.

ELECTRIC VEHICLE CALCULATION (per Section 5A-9-1-D)

1% OF TOTAL PARKING = 81 x 0.01 = 1 SPACES REQ'D.

NOTE: BOUNDARY AND TOPOGRAPHIC INFORMATION PROVIDED BY OTHERS, CARMINA WOOD DESIGN ASSUMES NO RESPONSIBILITY FOR ITS ACCURACY.



REVISIONS:	No.	Description	Date
1	1	Rev. per Town comments	12/23/25
2	2	Rev. per Town comments	1/13/26



DRAWING NAME:

Site Plan

Date: 9/22/25  
Drawn By: P. Sheedy  
Scale: As Noted

DRAWING NO.

C-100

Project No: 25-4116

All Rights Reserved. Reuse of these documents without the expressed written permission of CARMINA WOOD DESIGN is prohibited. WARNING: It is a violation of article 145 of the New York State Environmental Conservation Law to alter this drawing. If altered, the date, the signature, the date, the notation "Altered By" and a specific description of the alteration.

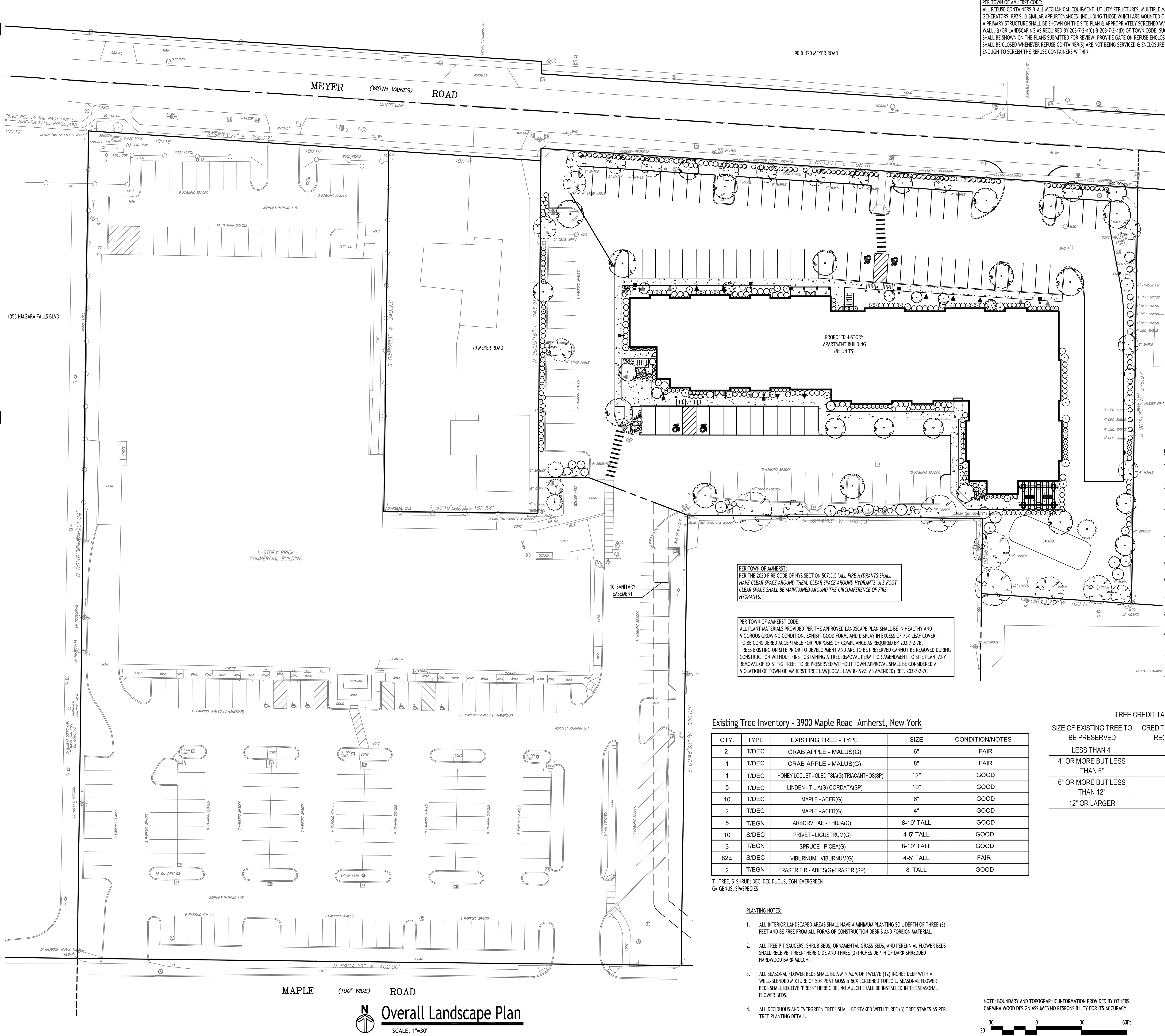

PER TOWN OF AMHERST CODE:  
ALL REFUSE CONTAINERS & ALL MECHANICAL EQUIPMENT, UTILITY STRUCTURES, MULTIPLE METER BOARDS, GENERATORS, RP2'S, & SIMILAR APPURTENANCES, INCLUDING THOSE WHICH ARE MOUNTED ON ANY PART OF A PRIMARY STRUCTURE SHALL BE SHOWN ON THE SITE PLAN & APPROPRIATELY SCREENED W/ A FENCE, WALL, &/OR LANDSCAPING AS REQUIRED BY 203-7-2-4(C) & 203-7-2-4(D) OF TOWN CODE. SUCH SCREENING SHALL BE SHOWN ON THE PLANS SUBMITTED FOR REVIEW. PROVIDE GATE ON REFUSE ENCLOSURE THAT SHALL BE CLOSED WHENEVER REFUSE CONTAINER(S) ARE NOT BEING SERVICED & ENCLOSURE SHALL BE HIGH ENOUGH TO SCREEN THE REFUSE CONTAINERS WITHIN.

PER TOWN OF AMHERST CODE:  
CONTRACTOR SHALL TAKE ALL REASONABLE MEASURES TO PROTECT EXISTING TREES WHICH ARE TO BE PRESERVED FROM ALL POSSIBLE TYPES OF ROOT, TRUNK, AND LIMB DAMAGE; INCLUDING BY NOT LIMITS TO, RETAIN WALLS WHICH PREVENT FILLING ON TOP OF ROOTS OR EXCAVATING TREE ROOTS AS PER ZONING ORDINANCE 7-2-3(B)(13).

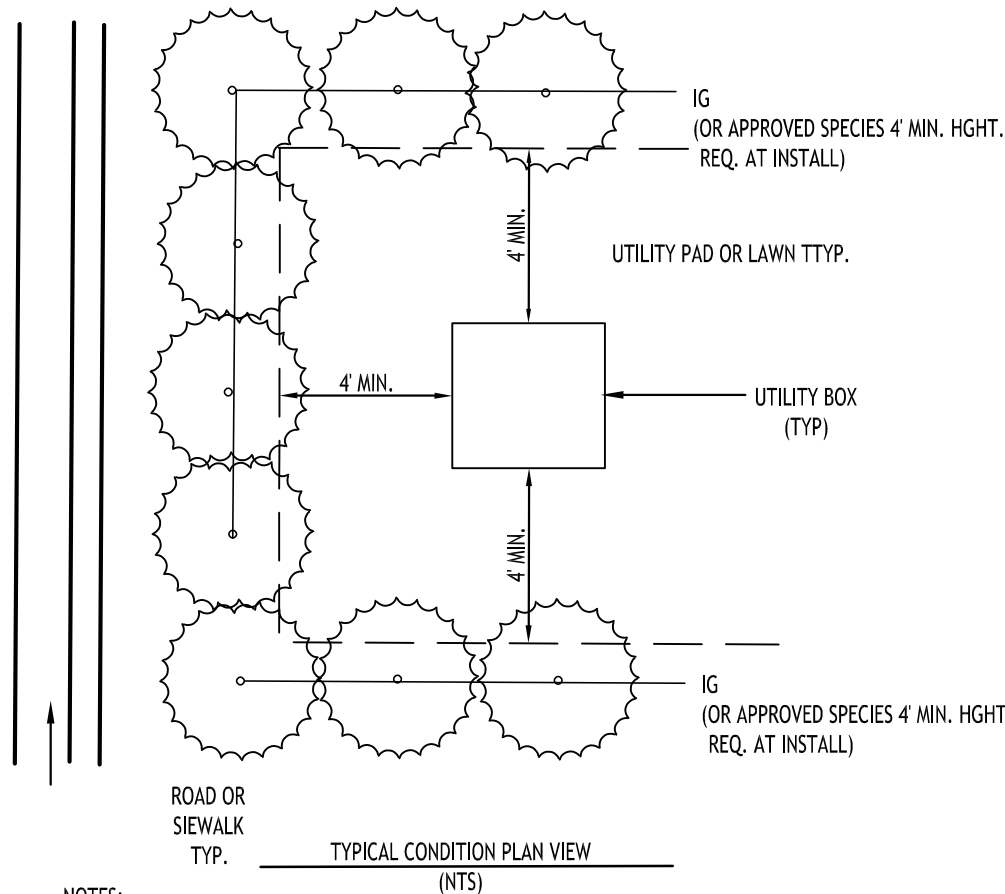

NOTES:

- USE EVERGREEN SHRUBS TO SCREEN ALL ABOVEGROUND UTILITY BOXES AND INFRASTRUCTURE FROM ADJACENT ROAD OR SIDEWALK PER TOWN OF AMHERST CODE
- PROVIDE A MINIMUM 4" OFFSET FROM THE SHRUBS PLANTED EDGE TO THE EDGE OF THE UTILITY BOX TO ALLOW ENOUGH CLEARANCE FOR UTILITY MAINTENANCE TO BE PERFORMED

TYPICAL SHRUB PLANTING TO SCREEN UTILITY INFRASTRUCTURE

LANDSCAPE NOTES:

- ALL PLANTS INSTALLED SHALL MEET OR EXCEED THE MINIMUM REQUIREMENTS AS NOTED ON THE PLANS AND IN THE LATEST EDITION ON THE AMERICAN STANDARD FOR NURSERY STOCK, BY THE AMERICAN ASSOCIATION OF NURSERYMEN, ANSI Z60.1
- THE CONTRACTOR SHALL BE RESPONSIBLE FOR HIS OWN QUANTITY TAKEOFF, THE QUANTITIES SHOWN ARE A MINIMUM AND ARE FOR REFERENCE ONLY.
- THE CONTRACTOR SHALL PERFORM A ROUGH FIELD STAKEOUT OF ALL PLANTING MATERIAL LOCATIONS AND CONTACT THE OWNERS FIELD REPRESENTATIVE PRIOR TO ACTUAL INSTALLING. THE PLANTING MATERIAL LOCATIONS SHOWN ON THE PLANS ARE TO CONVEY THE DESIGN INTENT ONLY, ACTUAL LOCATIONS WILL BE FINALIZED BY THE OWNERS FIELD REPRESENTATIVE AT THE TIME OF INSTALLATION.
- THE CONTRACTOR IS HEREBY NOTIFIED THAT IF UNDERGROUND UTILITIES EXIST IN THE VICINITY OF THE PLANTINGS, ALL PROPOSED PLANTINGS SHALL BE INSTALLED A MINIMUM OF 5' FROM ANY UNDERGROUND UTILITY, CONTACT THE OWNERS FIELD REPRESENTATIVE IF PLANTINGS SHOWN ON THE PLANS VIOLATE THIS SITUATION.
- ALL TREES SHALL BE INSTALLED A MINIMUM OF 20' FROM ANY OVERHEAD ELECTRIC LINES.
- PLANTING BACKFILL MIXTURE SHALL CONSIST OF 4 PARTS TOPSOIL, 1 PART PEAT MOSS,  $\frac{1}{2}$  PART WELL ROTTED MANURE, 10 LBS 5-10-5 PLANTING FERTILIZER THOROUGHLY MIXED PER CUBIC YARD.
- STAKE AND WRAP TREES IMMEDIATELY FOLLOWING INSTALLATION.
- ALL PLANTED AREAS SHALL RECEIVE A 3" LAYER OF SHREDDED PINE BARK MULCH OVER 10 MIL. WEED MAT EQUAL TO "WEEDBLOCK" BY EASY GARDENER OR DEWITT WEED BARRIER.
- THE AREAS ON THE PLAN TO BE SEEDED SHALL HAVE 4" MINIMUM OF TOPSOIL, DISK PLOWED, LEVELED AND HAND RAKED SMOOTH. SURFACE SHALL BE ROLLED TO REMOVE LUMPS.
- ALL SEEDED AREAS SHALL BE HYDROSEEDING IN ACCORDANCE WITH THE SPECIFICATION INDICATED. WHERE REQUIRED BY CLIMATIC CONDITIONS, SLOPE OR SEASON OF PLANTING, SOD MAY BE SUBSTITUTED FOR SEEDING IN ORDER TO ACHIEVE THE REQUIRED COVERAGE.
- THE CONTRACTOR SHALL BE RESPONSIBLE FOR WATERING, MOWING AND OTHER MAINTENANCE TO SEEDING AREAS UNTIL THE PROJECT IS ACCEPTED BY THE OWNER, THIS SHALL INCLUDE WATERING DAILY FOR 15 DAYS OR AS REQUIRED BY WEATHER CONDITIONS AND RE-SEEDING OF THIN SPOTS FOLLOWING THE GERMINATION OF THE SEEDS.

#### Existing Tree Inventory - 3900 Maple Road Amherst, New York

QTY.	TYPE	EXISTING TREE - TYPE	SIZE	CONDITION/NOTES
2	T/DEC	CRAB APPLE - MALUS(G)	6"	FAIR
1	T/DEC	CRAB APPLE - MALUS(G)	8"	FAIR
1	T/DEC	HONEY LOCUST - GLEDITSIA(G) TRICANTHOS(SP)	12"	GOOD
5	T/DEC	LINDEN - TILIA(G) CORDATA(SP)	10"	GOOD
10	T/DEC	MAPLE - ACER(G)	6"	GOOD
2	T/DEC	MAPLE - ACER(G)	4"	GOOD
5	T/EGN	ARBORVITAE - THUJA(G)	8-10' TALL	GOOD
10	S/DEC	PRIVET - LIGUSTRUM(G)	4-5' TALL	GOOD
3	T/EGN	SPRUCE - PICEA(G)	8-10' TALL	GOOD
82±	S/DEC	VIBURNUM - VIBURNUM(G)	4-5' TALL	FAIR
2	T/EGN	FRASER FIR - ABIES(G)-FRASER(SP)	8' TALL	GOOD

T= TREE, S=SHRUB, DEC=DECIDUOUS, EGN=EVERGREEN  
G=GENUS, SP=SPECIES

#### PLANTING NOTES:

- ALL INTERIOR LANDSCAPED AREAS SHALL HAVE A MINIMUM PLANTING SOIL DEPTH OF THREE (3) FEET AND BE FREE FROM ALL FORMS OF CONSTRUCTION DEBRIS AND FOREIGN MATERIAL.
- ALL TREE PIT SAUCERS, SHRUB BEDS, ORNAMENTAL GRASS BEDS, AND PERENNIAL FLOWER BEDS SHALL RECEIVE "PREEN" HERBICIDE AND THREE (3) INCHES DEPTH OF DARK SHREDED HARDWOOD BARK MULCH.
- ALL SEASONAL FLOWER BEDS SHALL BE A MINIMUM OF TWELVE (12) INCHES DEEP WITH A WELL-BLENDED MIXTURE OF 50% PEAT MOSS & 50% SCREENED TOPSOIL. SEASONAL FLOWER BEDS SHALL RECEIVE "PREEN" HERBICIDE. NO MULCH SHALL BE INSTALLED IN THE SEASONAL FLOWER BEDS.
- ALL DECIDUOUS AND EVERGREEN TREES SHALL BE STAKED WITH THREE (3) TREE STAKES AS PER TREE PLANTING DETAIL.

NOTE: BOUNDARY AND TOPOGRAPHIC INFORMATION PROVIDED BY OTHERS, CARMINA WOOD DESIGN ASSUMES NO RESPONSIBILITY FOR ITS ACCURACY.

TREE CREDIT TABLE	
SIZE OF EXISTING TREE TO BE PRESERVED	CREDIT TOWARDS NUMBER OF REQUIRED NEW TREES
LESS THAN 4"	0.5
4" OR MORE BUT LESS THAN 6"	1
6" OR MORE BUT LESS THAN 12"	2
12" OR LARGER	3

#### TOWN OF AMHERST APPROVAL BOX:

REVISIONS:	
No.	Description
1	Rev. per Town comments
2	Rev. per Town comments

Date  
12/23/25  
1/13/26



Robert C. Walter, RLA  
Registered Landscape Architect  
Member American Society of Landscape Architects  
2765 Dodge Road, East Amherst, NY 14051-2113  
Phone: 716-364-5564  
RCWlandscapearchitect@gmail.com

#### DRAWING NAME:

Landscape Plan  
Overall

Date: 9/22/25  
Drawn By: P. Sheedy  
Scale: As Noted

#### DRAWING NO.

L-100

Project No: 25-4116

All Rights Reserved. Reuse of these documents without the expressed written permission of CARMINA WOOD DESIGN is prohibited. WARNING: It is a violation of article 45 of the New York State Environmental Conservation Law to alter this drawing. If altered such R.A., P.E. or L.L.S. shall affix his or her seal, signature, the date the notation "Altered By" and a specific description of the alteration.

© CARMINA WOOD DESIGN

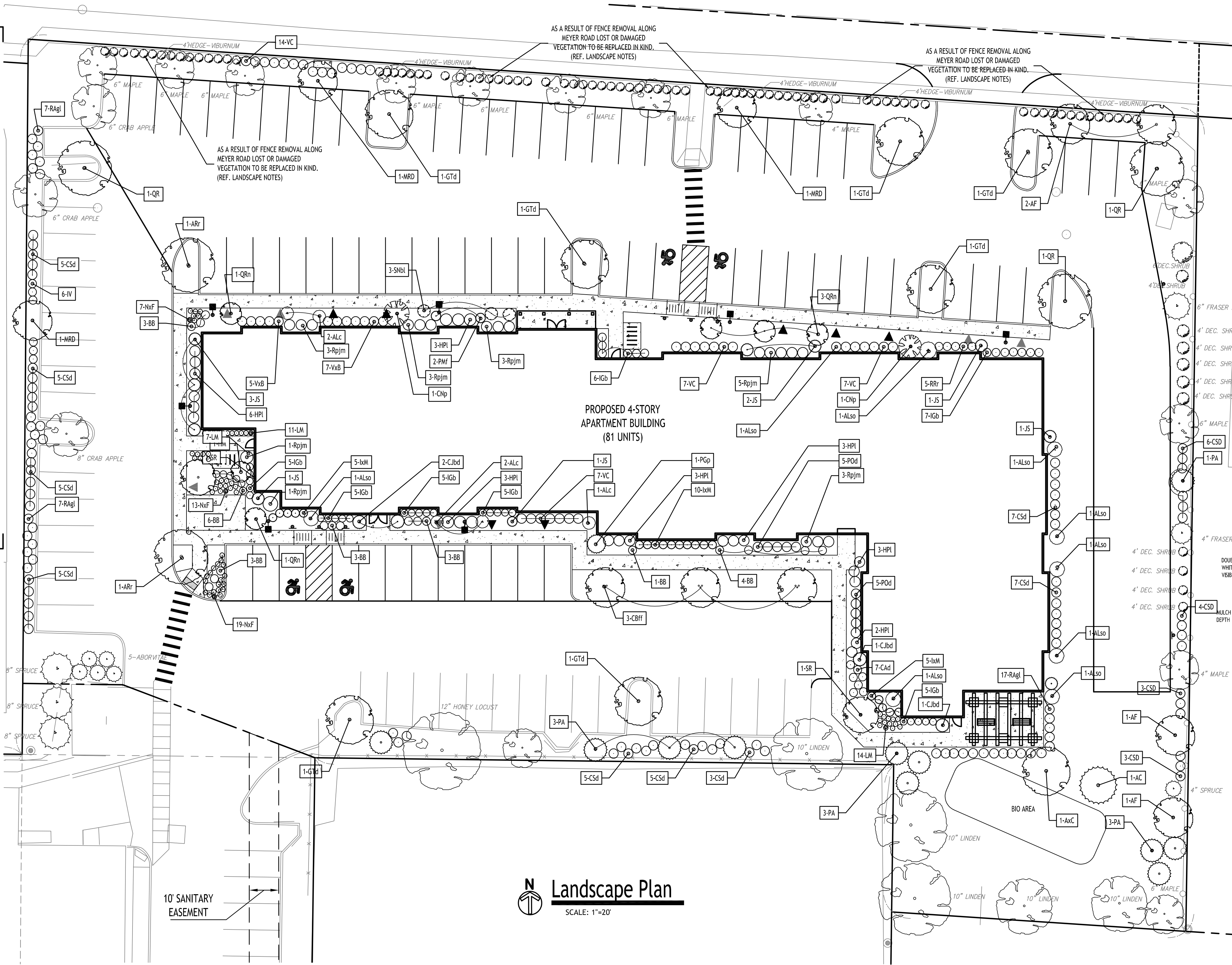

Plant Finish Schedule - 3900 Maple Road Amherst, New York

KEY	QTY.	BOTANICAL NAME	COMMON NAME	MIN. SIZE	REMARKS
DECIDUOUS TREES					
GTd	7	Gleditsia triacanthos 'I Draves'	Street Keeper Honey Locust	2 1/2" - 3" CAL.	B&B, HT. 40', W 35'
ARr	2	Acer rubrum 'Redpoint'	Red Maple - Redpointe	2 1/2" - 3" CAL.	B&B, HT. 45', W 30'
AXc	1	Aesculus x carnea 'Briotii'	Red Horse Chestnut	2 1/2" - 3" CAL.	B&B, HT. 60', W 40'
CBff	3	Carpinus betulus 'Frans Fontaine'	European Hornbeam - Frans Fontaine	2 1/2" - 3" CAL.	B&B, HT. 35', W 15'
QRn	7	Quercus robur x bicolor Nadler PP17604'	Kindred Spirit Oak	2 1/2" - 3" CAL.	B&B, HT. 30', W 6'
QR	7	Quercus rubru	Northern Red Oak	2 1/2" - 3" CAL.	B&B, HT. 60', W 35'
AF	1	Acer freemanii 'Jeffersred'	Freeman Maple	2 1/2" - 3" CAL.	B&B, HT. 45', W 30'

SMALL / ORNAMENTAL TREES					
CK	2	Cornus kousa	Kousa Dogwood	1 3/4" - 2 1/2" CAL.	B&B, HT. 20', W 20'
SR	2	Syringa reticulata	Ivory Silk Lilac	1 3/4" - 2 1/2" CAL.	B&B, HT. 20', W 15'
ALso	8	Amelanchier laevis 'Standing Ovation'	Standing Ovation Serviceberry	Multi Stem, Min. 10"H	B&B, HT. 20', W 10'
ALc	5	Amelanchier laevis 'cumulus'	Cumulus Serviceberry	Multi Stem, Min. 10"H	B&B, HT. 20', W 15'
HM	1	Heptacodium miconioides	Seven-son Flower	Multi Stem, Min. 10"H	B&B, HT. 20', W 8'
MRD	3	Malus x 'JFS-KW5'	Royal Raindrops Flowering Crabapple	Multi Stem, Min. 10"H	B&B, HT. 20', W 8'

EVERGREEN TREES					
JS	10	Juniperus scopulorum 'Skyrocket'	Skyrocket Juniper	6-8' Tall	B&B, HT. 18', W 4'
AC	2	Abies concolor	White Fir	6-8' Tall	B&B, HT. 60', W 20'
CNp	3	Chamaecyparis nootkatensis 'Pendula'	Weeping Nootka Cypress	6-8' Tall	B&B, HT. 20', W 8'
CJbd	6	Cryptomeria Japonica 'Black Dragon'	Back Dragon Japanese cedar	6-8' Tall	B&B, HT. 20', W 8'
PGp	1	Picea glauca 'Pendula'	Weeping White Spruce	6-8' Tall	B&B, HT. 25', W 6'
PMf	2	Pinus mugo 'Fastigiata'	Columnar Mugo Pine	24-36" Tall	B&B, HT. 15', W 6'
PA	11	Picea abies 'Hillside'	Upright Norway Spruce	24-36" Tall	B&B, HT. 18', W 6'

SHRUBS					
VxB	19	Viburnum x burkwoodii	Burkwood Viburnum	36-48" Tall	B&B, HT. 5-7', W 6'
IGb	40	Ilex glabra compacta	Inkberry Holly - Compact	24-36" Tall	B&B, HT. 4', W 4'
CSd	67	Cornus sericea	Red Twig Dogwood	24-36" Tall	B&B, HT. 4', W 4'
*Rpjm	19	Rhododendron RPJM	Rhodendron "PJM"	24-36" Tall	B&B, HT. 4', W 4'
*IxM	20	Ilex x meserveae	Blue Princess Holly	24-36" Tall	B&B, HT. 5', W 5'
SNbl	3	Sambucus nigra 'Eva' Black Lace	Black Elder	24-36" Tall	B&B, HT. 4', W 3'
RRr	5	Rosa radrazz	Knockout Rose	24-36" Tall	Cont. no.3 - 3'Tall, 3'Wide
HPI	23	Hydrangea paniculata 'Limelight'	Limelight Panicle Hydrangea	24-36" Tall	B&B, HT. 5', W 5'
CAd	7	Cotoneaster horizontalis	Rock Cotoneaster	18-24" Tall	B&B, HT. 3', W 6'
POd	29	Physocarpus opulifolius 'Diabolo'	Diablo Ninebark	24-36" Tall	B&B, HT. 4', W 4'
VC	29	Viburnum carlesii	Carlyle viburnum	24-36" Tall	B&B, HT. 5', W 6'
IV	6	Ilex verticillata 'FarrowMrP'	Mr Poppins Winterberry	24-36" Tall	B&B, HT. 5', W 6'

GRASSES / PERENNIALS / GROUNDCOVERS					
BB	23	Andropogon Gerardii	Big Blue Stem Andropogon	18-24" Tall	Cont. #3, HT. 4', W 6'
LM	53	Liriope muscari	Big Blue Lilyturf	12-16" Tall	Cont. no.3 - 3'Tall, 3'Wide
NxF	39	Nepeta x frassenii	Nepeta - Walkers Low Catmint	6-12" Tall	Cont. no.3 - 18" Tall, 1-4'Wide
RAgl	38	Rhus aromatica 'Gro-low'	Fragrant Sumac	18-24" Tall	Cont. #3, HT. 2-3, W 6'

\* EVERGREEN SHRUB

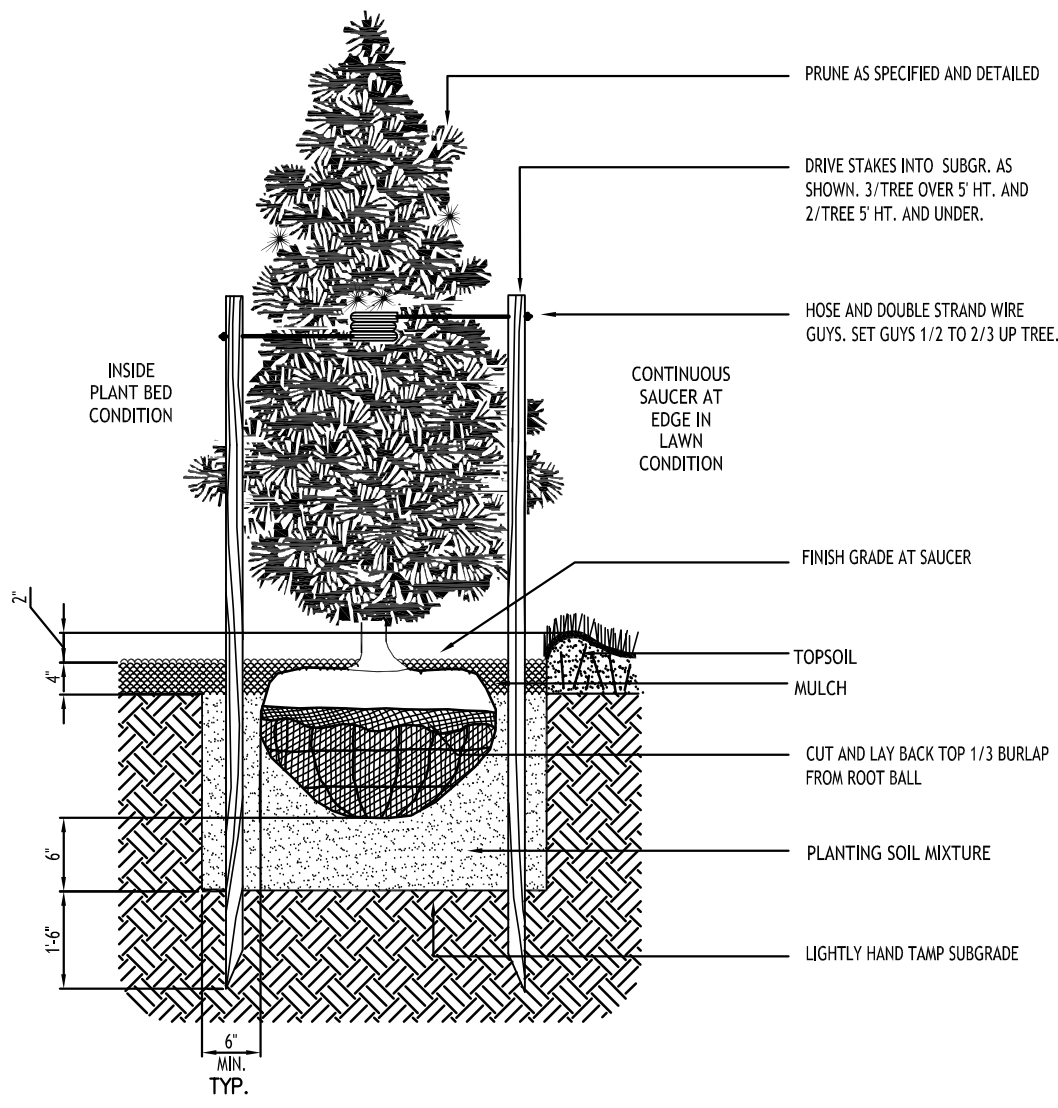

STD. EVERGREEN PLANTING

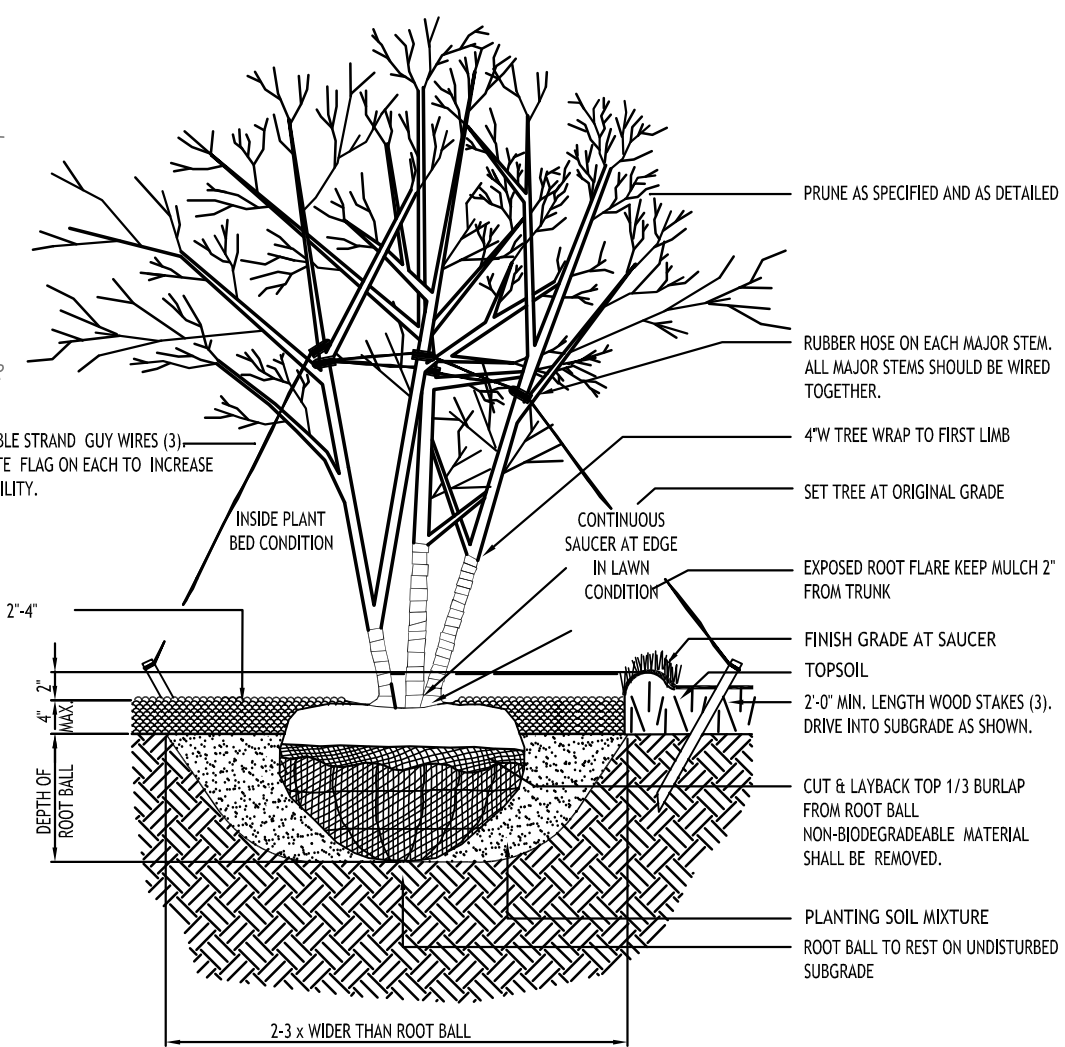

DECIDUOUS TREE PLANTING - MULTI - STEM

LEGEND

DECIDUOUS TREE

SMALL TREE

EVERGREEN TREE / SHRUB

BUSH / ORNAMENTAL GRASS

PERENNIAL

EXISTING TREES / SHRUBS

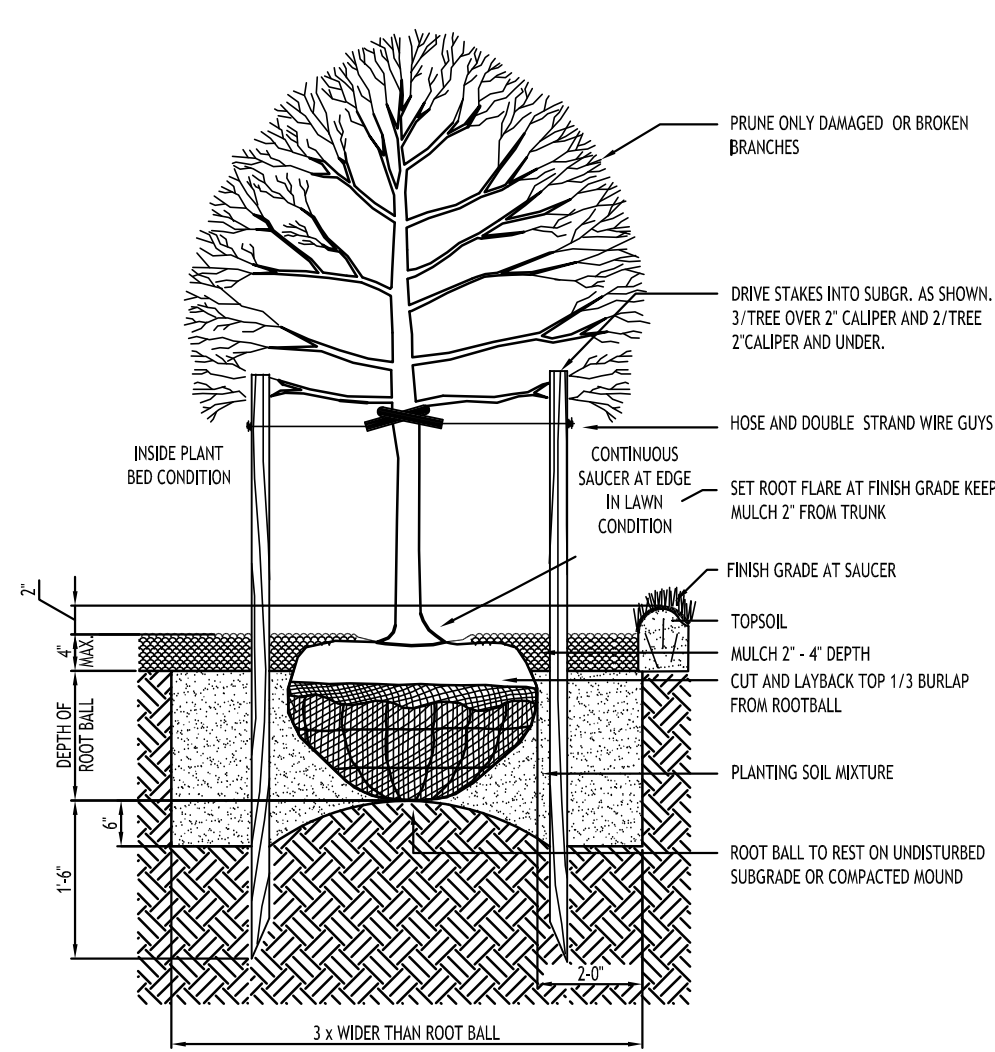

STD. DECIDUOUS TREE PLANTING

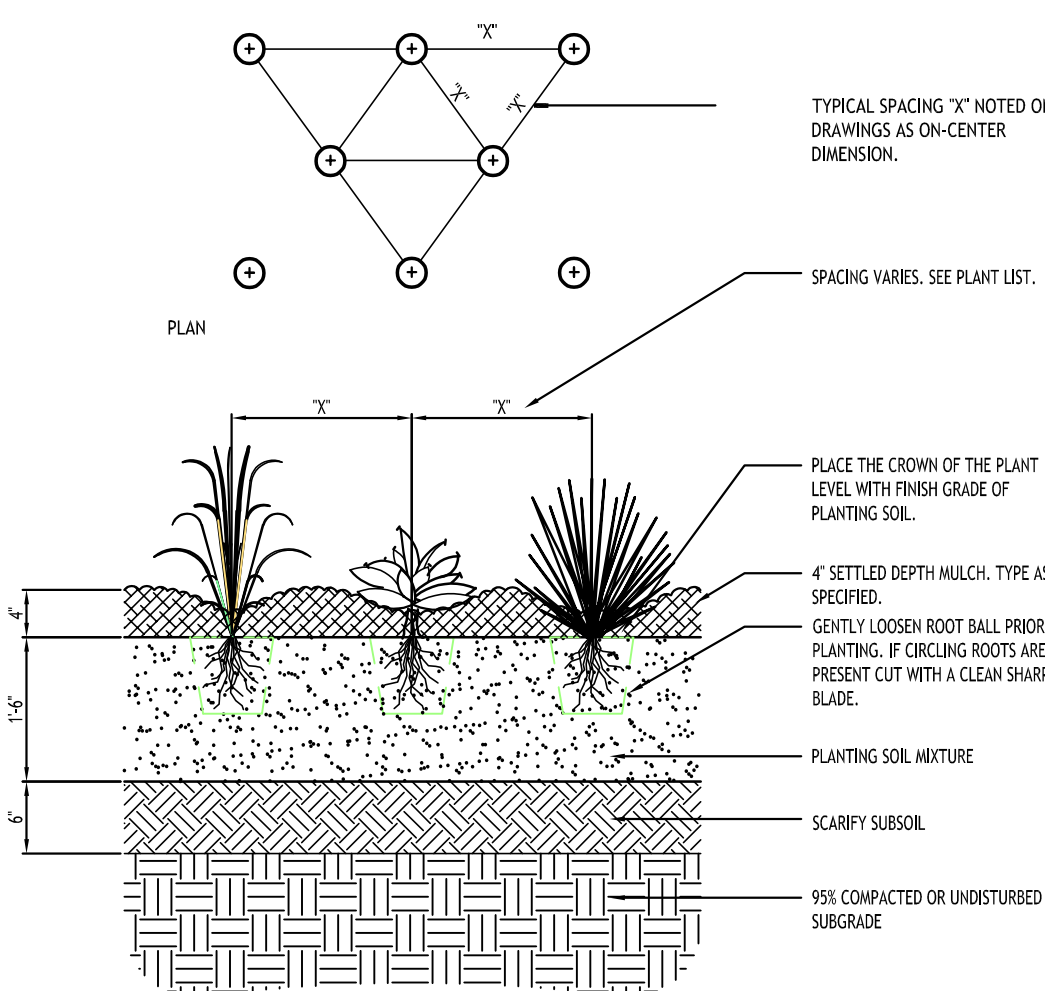

NOTE: PLANT BULBS IN TRENCHES AND BOUQUET PLANTING GROUPS.

GROUND COVER PLANT SPACING

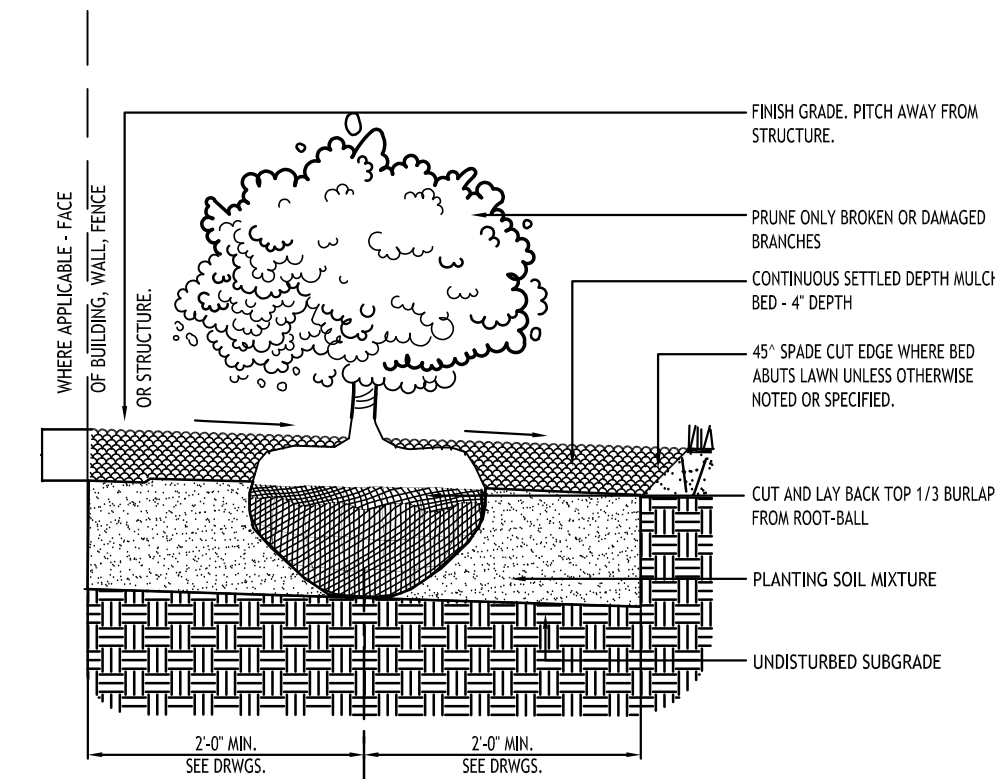

STD. SHRUB PLANTING

TOWN OF AMHERST APPROVAL BOX:

CARMINA WOOD

DESIGN

Buffalo | Utica | Greensboro

Legacy Village Senior Housing

3900 Maple Road

Amherst, NY

REVISIONS:	No.	Description	Date
	1	Rev. per Town comments	12/23/25
	2	Rev. per Town comments	1/13/26



Robert C. Walter, RLA

Registered Landscape Architect  
Member American Society of Landscape Architects  
2765 Dodge Road, East Amherst, NY 14051-2113  
Phone: 716-364-5564  
RCWLandscapearchitect@gmail.com

DRAWING NAME:

Landscape Plan  
& Details

Date: 9/22/25

Drawn By: P. Sheedy

Scale: As Noted

DRAWING NO.

L-101

Project No: 25-4116

ALL RIGHTS RESERVED. REUSE OF THESE DOCUMENTS WITHOUT THE EXPRESSED WRITTEN PERMISSION OF CARMINWOOD DESIGN IS PROHIBITED. WARNING! IT IS A VIOLATION OF ARTICLE 145 sections 720N and 7301 of the New York State Education Law for any person, unless acting under the direction of a registered architect, licensed engineer or land surveyor, to alter this drawing. If altered such R.A., P.E. or L.S. shall affix his or her seal, signature, the date the notation "Altered By" and a specific description of the alteration, to sections this drawing. If altered such R.A., P.E. or L.S. shall affix his or her seal, signature, the date the notation "Altered By" and a specific description of the alteration.

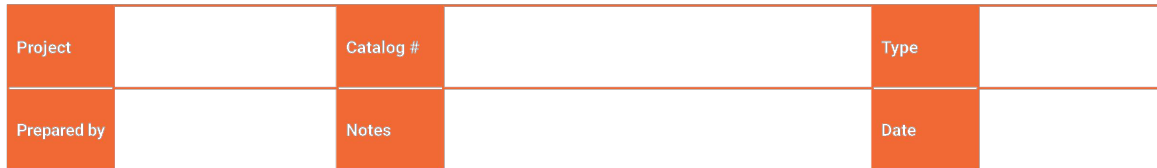

### Quick Facts

- Lumen packages range from 3,300 - 73,500 (33W - 552W)
- 17 optical distributions
- Efficacy up to 159 lumens per watt

### Connected Systems

- WaveLinux Lite
- WaveLinux



**NOTES:**  
1. Visit <https://www.designlights.org/search/> to confirm qualification. Not all product variations are DLC qualified.  
2. IGA Certified (3000K CCT and warmer only, fixed mounting options)

---

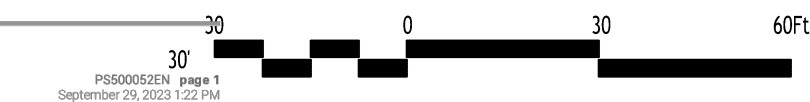
 **COOPER**  
Lighting Solutions



Lighting Calculations Prepared by Quality Lighting Systems  
For pricing please contact Paul Speicher at [pspeicher@qlsny.com](mailto:pspeicher@qlsny.com)

Luminaire Schedule										
Symbol	Qty	Label	Arrangement	Description	LLF	Luminaire Lumens	Luminaire Watts	Total Watts	Mounting Height	UG Rating
	3	SL1	Single	GALN-SA1A-740-U-T4W-HSS	0.900	3247	33	99	15	80-UG-G1
	4	SL2	Single	GALN-SA2A-740-U-T4BC	0.900	7417	55.8	223.2	15	80-UG-G3

Calculation Summary							
Label	CalcType	Units	Avg	Max	Min	AvgMin	MaxMin
Object_2_Planar	Summance	Fc	0.21	0.5	0.0	N.A.	N.A.
NORTH PARKING LOT SURFACE	Summance	Fc	1.00	0.6	0.1	10.00	66.00
SOUTH PARKING LOT SURFACE	Summance	Fc	1.21	1.6	0.5	2.42	3.20
WEST PARKING LOT SURFACE	Summance	Fc	1.16	1.8	0.3	3.87	6.00

TOWN OF AMHERST APPROVAL BOX:





Polaris  
 Fusion Type  
 Location:  
 Contact:

Wall Mounted - Damp Location Listed **PROGRESS LED**

## Description:

8" LED up/down dual cylinder - wall lantern in Black. The P6575 Series are designed for a wide variety of interior and exterior applications including residential and commercial. The Cylinder features a 120V alternating current suspension and eliminates the need for a traditional LED driver. The modular approach results in an encapsulated luminaire that utilizes performance, cost and safety benefits. Specify P656045 top cover lens for use in wet locations.

## Specifications:

- Black finish
- Powder coat finish
- One cast aluminum construction with durable powder coated finish
- 1/2" (12mm) aluminum vent per module (included)
- 3000° Kelvin temperature, 90+ CRI
- Meets California Title 24 high efficacy requirements for outdoor use only
- Dimmable to 10% with many LED drivers
- Dimmable to 10% brightness (See Dimming Notes)
- Black plate covers a standard 6" round outlet box 4.5" x W, 4.5" x H, 2.95" in depth
- Mounting strap for outlet box included
- 6 in of wire supplied

## Performance:

Number of Modules	2
Input Watts	117 W
Input Voltage	120V
Input frequency	60 Hz
Lumens/LPW (Down-Source)	795/LM (LM82) or module
Lumens/LPW (Up-Source)	795/LM (LM82) or module
Lumens/LPW (Down)	795/LM (LM82)
Lumens/LPW (Up)	1500/25 (50-75%)
CCT	3000 K
CRI	90+ CRI
Life (hours)	50,000 (30,000 Hrs)
EMC (EMI)	FCC Class A, Part 15, Class B
Max. Operating Temp	30°C
Warranty	3 Year Limited Warranty
Labels	CE/UL94 Damp Location Listed

# P5675-31/30K



## Dimensions:

Width: 8 in  
 Height: 4.4 in  
 Depth: 2.95 in  
 HxTxD: 8x8x4 in

701 Millbrook Blvd. Greenville, South Carolina 29607

[www.progresslighting.com](http://www.progresslighting.com)

Rev. 07/20

REVISIONS:		
No.	Description	Date
1	Rev. per Town comments	12/23/25
2	Rev. per Town comments	1/13/26



Date: 9/22/25  
 Drawn By: P. Sheedy  
 Scale: As Noted  
DRAWING NO.  
**LP-100**  
Project No: 25-4116

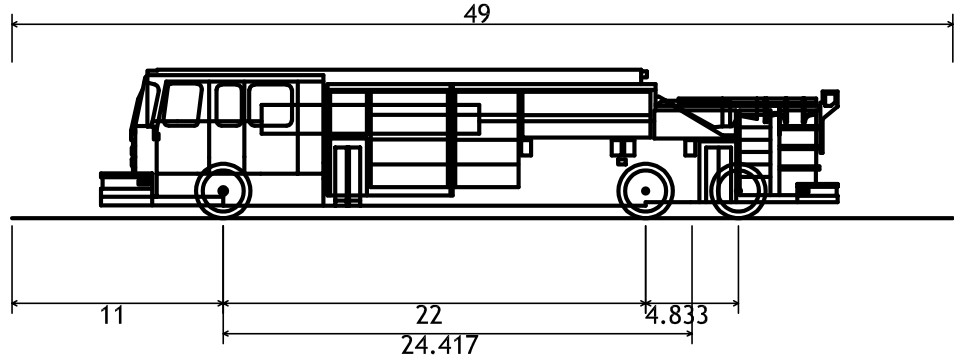
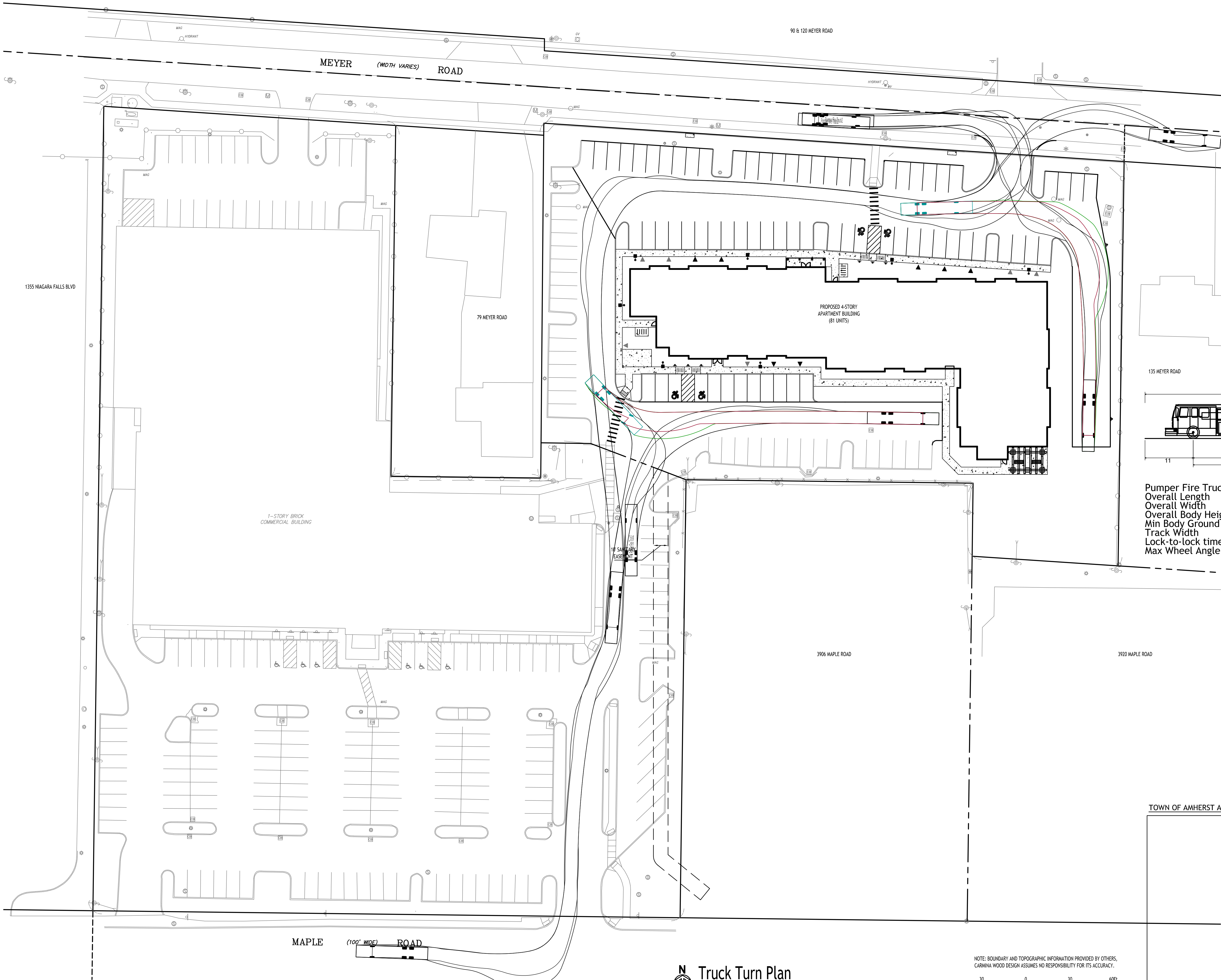

Pumper Fire Truck2  
Overall Length  
Overall Width  
Overall Body Height  
Min Body Ground Clearance  
Track Width  
Lock-to-lock time  
Max Wheel Angle

49.000ft  
8.167ft  
7.745ft  
0.656ft  
8.167ft  
5.00s  
45.00°

Truck Turn Plan  
SCALE: 1"=30'

NOTE: BOUNDARY AND TOPOGRAPHIC INFORMATION PROVIDED BY OTHERS, CARMINA WOOD DESIGN ASSUMES NO RESPONSIBILITY FOR ITS ACCURACY.



TOWN OF AMHERST APPROVAL BOX:



DRAWING NAME:

Truck Turn  
Plan

Date: 9/22/25  
Drawn By: P. Sheedy  
Scale: As Noted

DRAWING NO.

CT-100

Project No: 25-4116